

Sinnissippi Centers' Supervised Living Apartments



Parks Place Apartments
322 Depot Avenue
Dixon, IL 61021



Sullivan Apartments
1126 Healthcare Drive
Mt. Carroll, IL 61053



Fairview Apartments
555 Fairview Drive
Rochelle, IL 61068



Sterling Apartments
2104 East 23rd St.
Sterling, IL 61081

Supervised living environment in comfortable residential neighborhoods, with locations in Dixon, Mt. Carroll, Rochelle, and Sterling, Illinois.

For information, contact Sinnissippi Centers

Phone: 800-242-7642

Email: apts@sinnissippi.com

Full brochure online: [Click Here](#)

CURRENT VACANCIES

Updated 08-07-2019

<i>Apartment Site</i>	<i>Number of Vacancies</i>	<i>Date Available</i>
Parks Place Apartments, Dixon, IL	No vacancy	No units currently available
Sullivan Apartments, Mt. Carroll, IL	1 vacancy	Unit currently available
Fairview Apartments, Rochelle, IL	1 vacancy	Unit currently available
Sterling Apartments, Sterling, IL	1 vacancy	Unit currently available

What is Supervised Living?

Sinnissippi Centers' Supervised Living apartments are operated to provide **individuals with a serious mental illness** the opportunity to develop skills that will enable them to **live a more independent lifestyle**. Residents in these **rent subsidized apartments** (funded by the U.S. Department of Housing and Urban Development and the Department of Human Services) must meet certain restrictions (Click [HERE](#) for more information on restrictions in our online brochure).

What Are the Apartments Like?

Each **one-bedroom unfurnished apartment** is made up of a kitchen/dining area, living room, bedroom and bathroom. Utilities are included in the monthly subsidized rent. A large shared **community room** is also available to residents for get-togethers and includes a kitchen, table, couches, and TV for resident use. **Laundry facilities** are located **on site**.

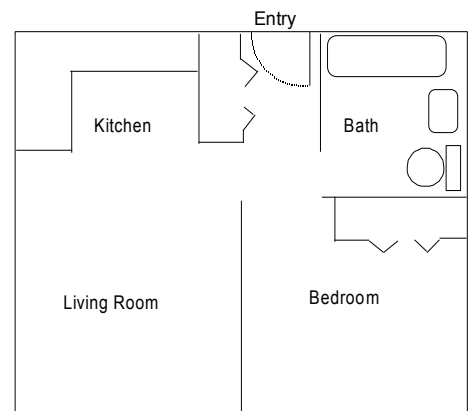

Typical Unit--Not drawn to scale. 538 sq.ft.



Sinnissippi Centers Supervised Living Apartments are a smoke-free environment.



SINNISSIPPI CENTERS

