

# Sinnissippi Centers' Supervised Apartments



**Parks Place Apartments**  
322 Depot Avenue  
Dixon, IL 61021



**Sullivan Apartments**  
1126 Healthcare Drive  
Mt. Carroll, IL 61053



**Fairview Apartments**  
555 Fairview Drive  
Rochelle, IL 61068



**Sterling Apartments**  
2104 East 23rd St.  
Sterling, IL 61081

**Supervised living environment in comfortable residential neighborhoods, with locations in Dixon, Mt. Carroll, Rochelle, and Sterling, Illinois.**

**For information, contact Sinnissippi Centers**

**Phone: 800-242-7642**

**Email: [apts@sinnissippi.com](mailto:apts@sinnissippi.com)**

## CURRENT VACANCIES

*Updated 06-06-2018*

<i>Apartment Site</i>	<i>Number of Vacancies</i>	<i>Date Available</i>
Parks Place Apartments, Dixon, IL	1 vacancy	Unit currently available
Sullivan Apartments, Mt. Carroll, IL	1 vacancy	Unit currently available
Fairview Apartments, Rochelle, IL	No vacancy	No units currently available
Sterling Apartments, Sterling, IL	1 vacancy	Unit is currently available

### What is Supervised Living?

Sinnissippi Centers' supervised apartments are operated to provide **individuals with a serious mental illness** the opportunity to develop skills that will enable them to **live a more independent lifestyle**. Residents in these **rent subsidized apartments** (funded by the U.S. Department of Housing and Urban Development and the Department of Human Services) must meet certain restrictions (Click [HERE](#) for more information on restrictions in our online brochure).

### What Are the Apartments Like?

Each **one-bedroom unfurnished apartment** is made up of a kitchen/dining area, living room, bedroom and bathroom. Utilities are included in the monthly subsidized rent. A large shared **community room** is also available to residents for get-togethers and includes a kitchen, table, couches, and TV for resident use. **Laundry facilities** are located **on site**.

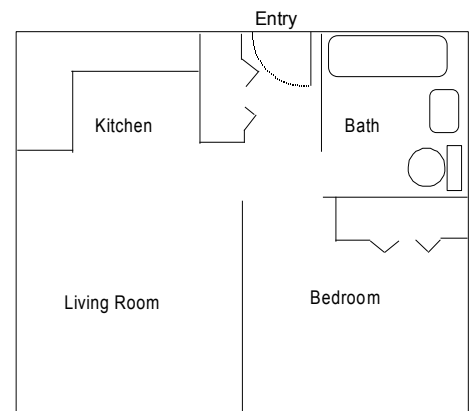

Typical Unit--Not drawn to scale. 538 sq.ft.



**Sinnissippi Centers Supervised Apartments are a smoke-free environment.**



**SINNISSIPPI CENTERS**

