

# Sinnissippi Centers' Supervised Apartments



**Parks Place Apartments**  
322 Depot Avenue  
Dixon, IL 61021



**Sullivan Apartments**  
1126 Healthcare Drive  
Mt. Carroll, IL 61053



**Fairview Apartments**  
555 Fairview Drive  
Rochelle, IL 61068



**Sterling Apartments**  
2104 East 23rd St.  
Sterling, IL 61081

**Supervised living environment in comfortable residential neighborhoods, with locations in Dixon, Mt. Carroll, Rochelle, and Sterling, Illinois.**

*For information, contact Sinnissippi Centers*

**Phone: 800-242-7642**

**Email: [apts@sinnissippi.com](mailto:apts@sinnissippi.com)**

## CURRENT VACANCIES

*Updated 04-12-2018*

<i>Apartment Site</i>	<i>Number of Vacancies</i>	<i>Date Available</i>
Parks Place Apartments, Dixon, IL	No vacancy	No units currently available
Sullivan Apartments, Mt. Carroll, IL	No vacancy	No units currently available
Fairview Apartments, Rochelle, IL	No vacancy	No units currently available
Sterling Apartments, Sterling, IL	2 vacancies	Both units currently available

### What is Supervised Living?

Sinnissippi Centers' supervised apartments are operated to provide **individuals with a serious mental illness** the opportunity to develop skills that will enable them to **live a more independent lifestyle**. Residents in these **rent subsidized apartments** (funded by the U.S. Department of Housing and Urban Development and the Department of Human Services) must meet certain restrictions (Click [HERE](#) for more information on restrictions in our online brochure).

### What Are the Apartments Like?

Each **one-bedroom unfurnished apartment** is made up of a kitchen/dining area, living room, bedroom and bathroom. Utilities are included in the monthly subsidized rent. A large shared **community room** is also available to residents for get-togethers and includes a kitchen, table, couches, and TV for resident use. **Laundry facilities** are located **on site**.

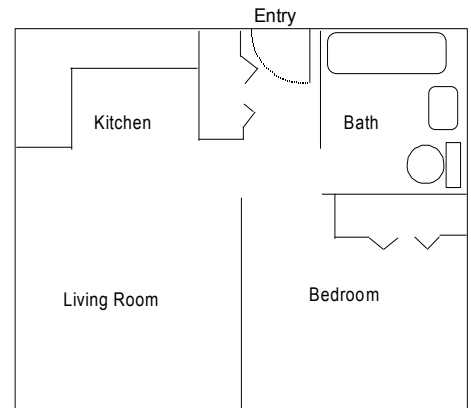

Typical Unit--Not drawn to scale. 538 sq.ft.



**Sinnissippi Centers Supervised Apartments are a smoke-free environment.**



**SINNISSIPPI CENTERS**

