

Sinnissippi Centers' Residential Services



*Providing a supportive living
environment for individuals
with a serious mental illness
in comfortable residential
neighborhoods*



SINNISSIPPI CENTERS

WHAT IS RESIDENTIAL LIVING?

Sinnissippi Centers' Residential Services apartments are operated to provide **individuals with a serious mental illness** the opportunity to develop skills that will enable them to **live a more independent lifestyle**.

Residents in these **rent subsidized apartments** must meet certain criteria.

ADMISSION CRITERIA INCLUDE

- Diagnosed with a serious mental illness
- Require a supervised living environment
- Need to have Medicaid coverage
- Interest in improving living skills
- Meet certain income restrictions
- Compliance with medications
- Agreeable to abiding by the house rules set by the staff and residents
- IQ 70 or higher
- Must pass a criminal background check

WHAT ARE THE APARTMENTS LIKE?

Each one-bedroom unfurnished apartment has a:

- Kitchen/dining area
- Living room
- Bedroom
- Bathroom
- Utilities are included in the monthly subsidized rent

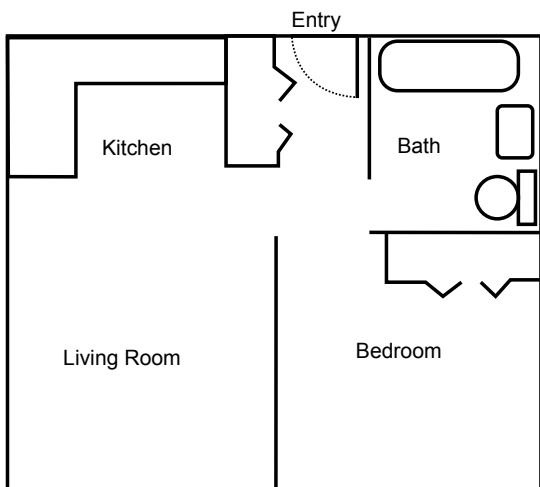

Typical Unit - *Not drawn to scale.* 538 sq. ft.

A large shared Community Room is also available to residents for get-togethers and includes a kitchen, table, couches, and TV for resident use.

Laundry facilities are located on site.

Living in this apartment complex is **maintenance free** - no snow to shovel or grass to mow!

SERVICES PROVIDED

Sinnissippi Centers' Residential Services apartment staff are on premises 24-hours a day and provide many services



- Counseling
- Advocacy
- Crisis
- Representative payee services
- Recreation activities
- Medication management training
- Facilitation of consumer run groups and activities
- Skills teaching to improve activities of daily living

OUTCOMES

Desired outcomes specific to Residential Apartment Living may include change in the following areas:

- Independent living
- Quality of life
- Consumer satisfaction
- Functioning level
- Community integration
- Symptoms management
- Access to health care
- Activities of daily living
- Reduction of hospitalization

WHERE THEY ARE LOCATED

Rochelle - Fairview Apartments

Fairview Apartments are located on the north side of Rochelle close to grocery stores, restaurants, retail and banking resources. It is an in-town location with easy access to the walking/bike trail.



Dixon - Parks Place Apartments

Parks Place apartments are located on Depot Avenue in a residential area with easy access to shopping areas, the YMCA and post office.



Parks are located nearby along the Rock River, including the 240 acre Lowell Park. There are many recreational facilities providing convenient access for sporting or leisure activities.

Sterling - Sterling Apartments

Sterling apartments offers 12 units. These apartments are located north of downtown and provide easy access to the YMCA, restaurants and shopping. In addition, Sterling is home to a regional hospital as well as several clinics, dental offices, chiropractic services and behavioral health centers to meet the health needs of the community.



Mt. Carroll - Sullivan Apartments

Sullivan apartments accommodate eight individuals and is located in Mt. Carroll just 11 miles east of the Mississippi River on a picturesque site from which one has a view of the rolling hills and farm fields for miles.



FOR MORE INFORMATION

Contact the Sinnissippi Residential Services Apartment location nearest you by using one of the phone numbers below. You can also contact us by email or online at www.sinnissippi.org.

Fairview Apartments, Rochelle

815-561-9003

Parks Place Apartments, Dixon

815-288-6057

Sterling Apartments, Sterling

815-622-0938

Sullivan Apartments, Mt. Carroll

815-244-4200

EMAIL

apts@sinnissippi.com

Funding for Sinnissippi Center's Residential Services Apartments provided in whole, or in part, by the Illinois Department of Human Services and the U.S. Department of Housing and Urban Development

Sinnissippi Centers is accredited and licensed by the State of Illinois to provide Medicaid services

Sinnissippi Center's Residential Services Apartments are a smoke-free environment



All qualified applicants will receive consideration without regard to race, ethnicity, or religion

